



End Terrace House 'To Let'
£1,250 PCM
Woodlands Road, Charfield



KEY FEATURES

Two Bedroom House - Cul-de-Sac Location - Village Setting - Gas C/H - Double Glazing - Enclosed Rear Garden - Single Garage - Allocated Parking - Unfurnished.
EPC - [[EPCImages.EERImage.CurrentAsLetter]] - DEPOSIT £1442.00

Description

A well presented two bedroom end terraced house, offered on an unfurnished basis and comprising; entrance hall, kitchen with white goods and lounge with doors leading on to an enclosed garden. Upstairs you will find the family bathroom with an electric shower over bath and two good size bedrooms. Further benefits include newly fitted gas boiler, double glazing, a single garage with power and lighting and allocated parking for at least two cars. Would ideally suit a single professional person or couple. No pets. Available now for six months to long term (EPC-D)



Situation

The village of Charfield is situated approximately 2.7 miles from Junction 14 of the M5 at Falfield, connecting from there directly to Bristol in the South and Cheltenham/Gloucester to the North. The local town centre of Wotton-under-Edge is approximately 2 miles to the East, passing the road to Katharine Lady Berkeley's secondary school en-route. Charfield has a popular primary school, convenience stores, Public Houses and a petrol station.



Local Authority & Council Tax

South Gloucestershire Council
Council Tax Band - C



Contact & Viewing

T: 01454 417336
w: www.milburys.co.uk

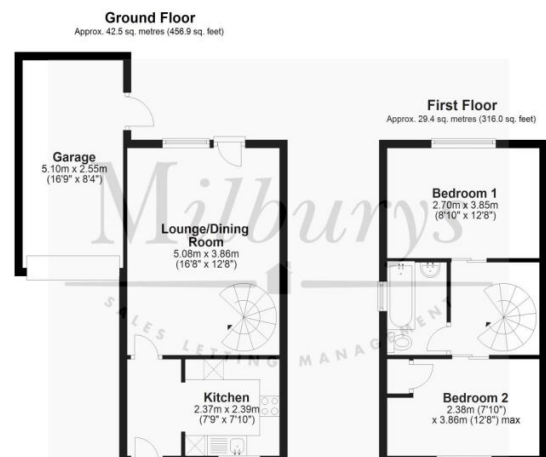

Floorplan

Ground Floor

Approx. 42.5 sq. metres (456.9 sq. feet)



Additional Photos

Important Notice

Milburys Estate Agents Ltd, their clients and any joint agents give notice that they have not tested any apparatus, equipment, fixtures, fittings, heating systems, drains or services and so cannot verify they are in working order or fit for their purpose. Interested parties are advised to obtain verification from their surveyor or relevant contractor. Statements pertaining to tenure are also given in good faith and should be verified by your legal representative. Digital images may, on occasion, include the use of a wide-angle lens. Please ask if you have any queries about any of the images shown, prior to viewing. Where provided, floor plans are shown purely as an indication of layout. They are not scale drawings and should not be treated as such. Complete listings and full details of all our properties (both for sale and to let) are available at www.milburys.co.uk