

Apartment 'To Let'
£995 PCM
Beechacres, Thornbury



KEY FEATURES

Loft Apartment - Grade II Listed Former Workhouse - Vaulted Beamed Ceilings - Cloakroom - Dual-Aspect Lounge - Kitchen/Dining Room, Appliances - Dual-Aspect Double Bedroom With Built-In Double Wardrobe - En-Suite With Shower Cubicle, WC & Wash-Basin - Double-Glazing - Electric Heating - Single Numbered Parking Space - Beautifully Managed Communal Gardens - Communal Bin/Recycling Store.

EPC - E - DEPOSIT £1148.00

Description

Come and view this smartly-presented first floor 'loft' apartment in Thornbury's former work-house at Beechacres, the fine Grade II development completed by Crest Nicholson. The living room is dual-aspect with four windows and a high beamed and vaulted ceiling, the kitchen/dining room plus integrated appliances that include hob, oven, fridge/freezer and washing machine. It even has a cloakroom and WC. The dual-aspect bedroom is a generous double size, with a vaulted beamed ceiling, double wardrobe and an en-suite with shower cubicle, WC and wash-basin. The windows are double-glazed and the heating is electric. The apartment shares its entrance with four other properties and also benefits from managed communal gardens and a private allocated parking space to the front. Available now.



Situation

Thornbury is a thriving market town where the High Street offers a variety of shops, cafes, pubs and restaurants. Facilities include the Leisure Centre, Golf Course and Library. The town is blessed with a number of primary and junior schools, all feeding into The Castle secondary school (www.castle.gloucs.sch.uk) which is situated on the edge of open countryside close to Thornbury Castle.

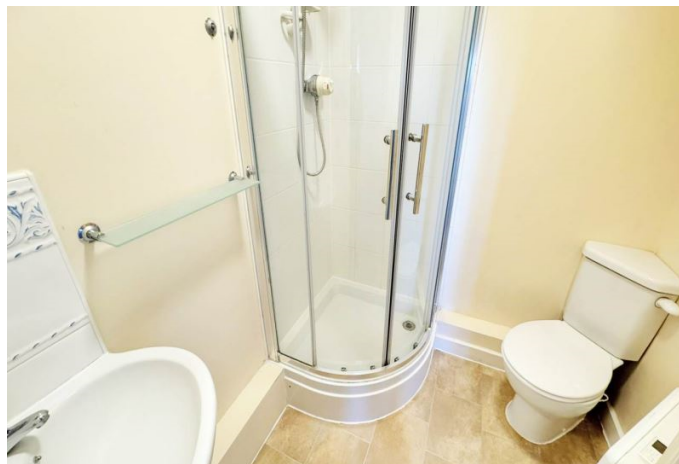

Local Authority & Council Tax

SouthGloucestershireCouncil
Council Tax Band - B



Contact & Viewing

T: 01454 417336
w: www.milburys.co.uk



Floorplan



Total area: 610 sq. feet

Additional Photos

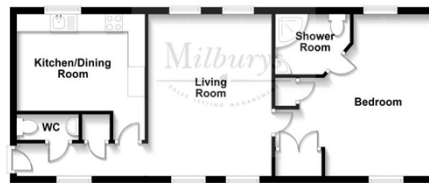

Total area: 610 sq. feet

Important Notice

Milburys Estate Agents Ltd, their clients and any joint agents give notice that they have not tested any apparatus, equipment, fixtures, fittings, heating systems, drains or services and so cannot verify they are in working order or fit for their purpose. Interested parties are advised to obtain verification from their surveyor or relevant contractor. Statements pertaining to tenure are also given in good faith and should be verified by your legal representative. Digital images may, on occasion, include the use of a wide-angle lens. Please ask if you have any queries about any of the images shown, prior to viewing. Where provided, floor plans are shown purely as an indication of layout. They are not scale drawings and should not be treated as such. Complete listings and full details of all our properties (both for sale and to let) are available at www.milburys.co.uk