

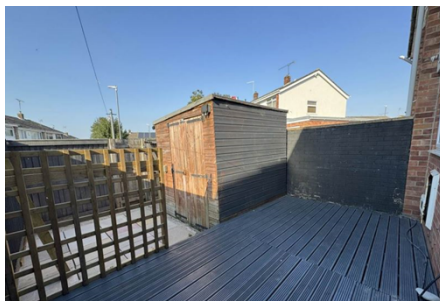

House 'To Let'  
**£1,250 PCM**  
Wharfedale, Thornbury



**KEY FEATURES**

Spacious Three-Bedroom Terrace House - Gas Central Heating - Double Glazing - Lounge/Diner - Shower Room - Enclosed Rear Patio Garden - Unfurnished - (EPC- C).

**EPC - D - DEPOSIT £1442.00**

## Description

This modern mid-terrace house is situated in the market-town of Thornbury, overlooking open green space to the front and convenient for the town centre with all its amenities. The well-presented accommodation is offered on an unfurnished basis and comprises three bedrooms, bathroom, lounge, kitchen/dining room and entrance porch. Benefits include Upvc double-glazing and gas central heating. There is an open plan garden to the front and an enclosed rear garden with two off-street parking spaces. Available 1st October 2024 for six months to long term.



## Situation

Thornbury is a thriving market town where the High Street offers a variety of shops, cafes, pubs and restaurants. Facilities include the Leisure Centre, Golf Course and Library. The town is blessed with a number of primary and junior schools, plus The Castle secondary school ([www.castle.gloucs.sch.uk](http://www.castle.gloucs.sch.uk)) which is situated on the edge of open countryside close to Thornbury Castle.



## Local Authority & Council Tax

SouthGloucestershireCouncil  
Council Tax Band - B



## Contact & Viewing

T: 01454 417336  
w: [www.milburys.co.uk](http://www.milburys.co.uk)



## Floorplan

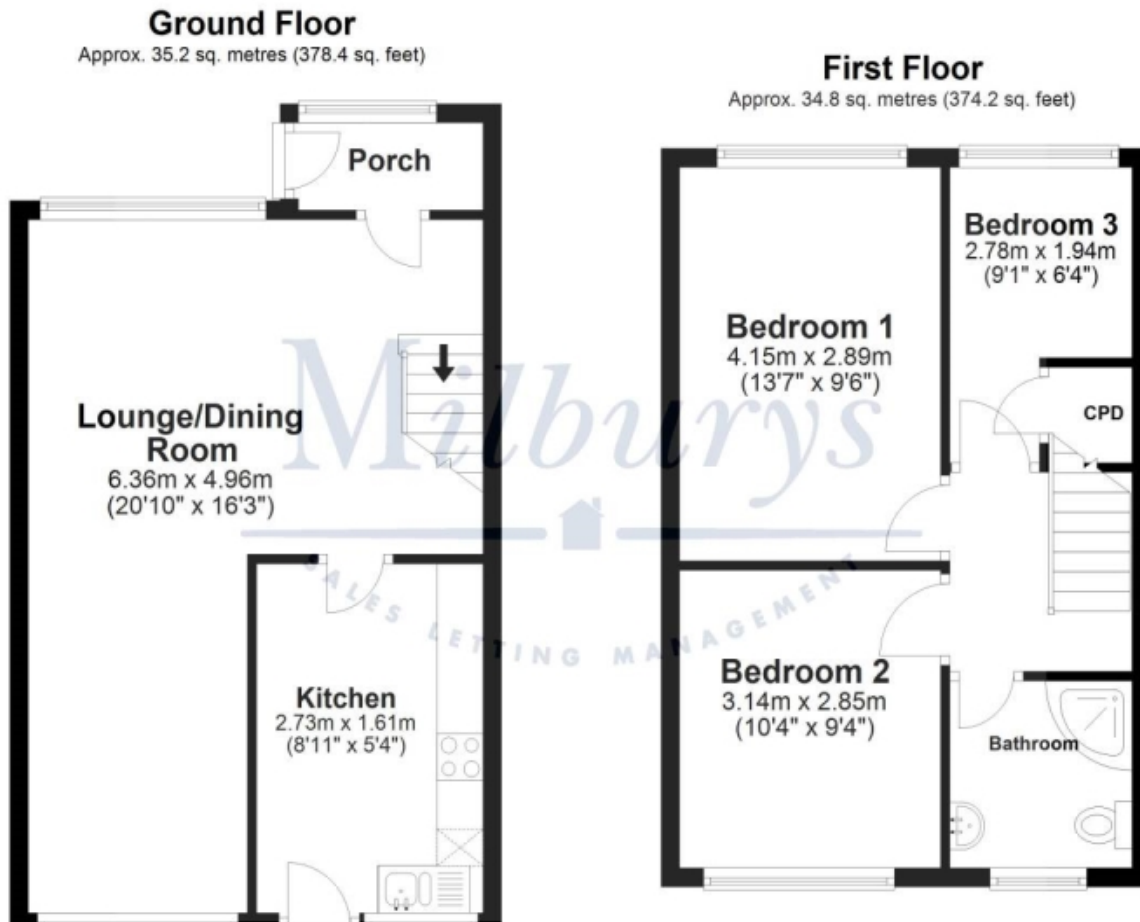

## Additional Photos



## Important Notice

Milburys Estate Agents Ltd, their clients and any joint agents give notice that they have not tested any apparatus, equipment, fixtures, fittings, heating systems, drains or services and so cannot verify they are in working order or fit for their purpose. Interested parties are advised to obtain verification from their surveyor or relevant contractor. Statements pertaining to tenure are also given in good faith and should be verified by your legal representative. Digital images may, on occasion, include the use of a wide-angle lens. Please ask if you have any queries about any of the images shown, prior to viewing. Where provided, floor plans are shown purely as an indication of layout. They are not scale drawings and should not be treated as such. Complete listings and full details of all our properties (both for sale and to let) are available at [www.milburys.co.uk](http://www.milburys.co.uk)