

House 'To Let'

£1,080 PCM

The Tallet, Nupdown, Nr Oldbury On Severn



KEY FEATURES

Two Bedroom - Detached Barn - Entrance Porch - Kitchen/Diner With Fitted Dishwasher, Cooker/Hob & Fridge - Utility Room - Cloakroom - Two Bedrooms - Bathroom With Shower Over Bath - Parking For Two Cars - Garden - Oil Fired C/H - Unfurnished
EPC - D - DEPOSIT £1246.00

Description

PLEASE NOTE THAT THIS PROPERTY CAN ONLY BE OCCUPIED BY A PERSON WORKING OR MAINLY WORKING OR LAST WORKING IN AGRICULTURE OR IN FORESTRY OR A WIDOW OR WIDOWER OF SUCH A PERSON AND TO ANY RESIDENT DEPENDENTS. The original barn structure has been carefully converted to give a well planned two-bedroomed barn & comprises of an entrance porch, open plan kitchen/diner with dishwasher, fridge & cooker/hob, utility room, cloakroom & a lovely lounge. The master bedroom has a fitted wardrobe and storage & the bathroom has a shower over bath. Outside you have a garden with a patio area & grass area leading to parking for two cars. Available unfurnished for six month to long term. The property further benefits from oil fired central heating & double glazing. EPC - D



Situation

Oldbury-on-Severn is situated in excellent riding country, approximately 2 miles to the west of the market town of Thornbury, the local centre with high street shops, banks, supermarkets, leisure centre, secondary school, golf club and Tudor castle - now a private hotel. The village itself has a primary school and church, a community shop and cafe, public house and sailing club. There is good access to the M4 and M5, Bristol is easily commutable and Bristol Parkway station is approximately 11.5 miles to the south.



Local Authority & Council Tax

Council Tax Band - C



Contact & Viewing

T: 01454 417336

w: www.milburys.co.uk



Floorplan

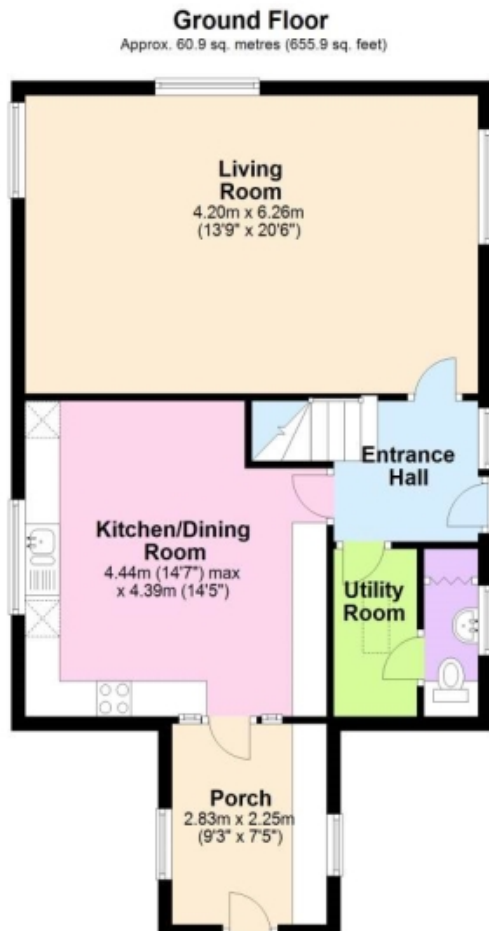

Additional Photos



Important Notice

Milburys Estate Agents Ltd, their clients and any joint agents give notice that they have not tested any apparatus, equipment, fixtures, fittings, heating systems, drains or services and so cannot verify they are in working order or fit for their purpose. Interested parties are advised to obtain verification from their surveyor or relevant contractor. Statements pertaining to tenure are also given in good faith and should be verified by your legal representative. Digital images may, on occasion, include the use of a wide-angle lens. Please ask if you have any queries about any of the images shown, prior to viewing. Where provided, floor plans are shown purely as an indication of layout. They are not scale drawings and should not be treated as such. Complete listings and full details of all our properties (both for sale and to let) are available at www.milburys.co.uk