



Flat / Apartment 'To Let'
£1,100 PCM
Church Lane, Old Sodbury



KEY FEATURES

First Floor Apartment - Semi-Rural Village Location - Lounge - Kitchen with Cooker, Fridge/Freezer And Washing Machine - Two Double Bedrooms - Bathroom - Double Glazing - Electric Central Heating - Garage With Power And Lighting - One Off Street Parking Space - Elevated Private Garden - Unfurnished.
EPC - E - DEPOSIT £1269.00

Description

A first floor apartment, forming part of a converted cottage and situated in the semi-rural village of Old Sodbury. There are beautiful countryside walks on your doorstep, yet you are close commuting distance to junction 18 of the M4. You enter the property through a small entrance hallway at ground level, heading upstairs to the main living accommodation on the first floor. Here you will find the unfurnished accommodation comprising lounge, a fitted kitchen complete with a cooker, fridge/freezer and integral washing machine, two double bedrooms and bathroom. A major bonus includes a single garage to the rear and one off-street parking space. In addition the property benefits from an elevated garden terrace with far reaching countryside views. Further benefits include electric heating and double glazing. Available now for six months to long term. No smokers. Would suit a single person or couple.



Situation

Old Sodbury is a popular village with a lovely countryside setting. It is quite literally on the Cotswold Way so ideal for walking but is also just a very short drive to the local market town of Chipping Sodbury. Nearby the A46 provides easy access to the M4 Junction 18 (approx 3 miles) making both Bristol and Bath within commuting distance. The attractive Cotswold countryside is on its very doorstep with Westonbirt Arboretum and Tetbury also being an easy drive. The village itself has a C.O.E Primary School alongside the picturesque Church with its stunning views over the Severn, a private nursery, public house/restaurant, petrol station, hotel, Frome Valley Walk and of course the historic Cotswold Way walk.



Local Authority & Council Tax

South Gloucestershire Council
Council Tax Band - B



Contact & Viewing

T: 01454 417336
w: www.milburys.co.uk



Floorplan

First Floor

Approx. 67.9 sq. metres (730.4 sq. feet)



Ground Floor

Approx. 1.8 sq. metres (19.5 sq. feet)

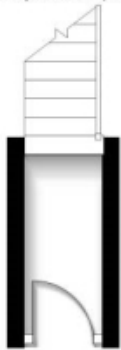

Additional Photos



Important Notice

Milburys Estate Agents Ltd, their clients and any joint agents give notice that they have not tested any apparatus, equipment, fixtures, fittings, heating systems, drains or services and so cannot verify they are in working order or fit for their purpose. Interested parties are advised to obtain verification from their surveyor or relevant contractor. Statements pertaining to tenure are also given in good faith and should be verified by your legal representative. Digital images may, on occasion, include the use of a wide-angle lens. Please ask if you have any queries about any of the images shown, prior to viewing. Where provided, floor plans are shown purely as an indication of layout. They are not scale drawings and should not be treated as such. Complete listings and full details of all our properties (both for sale and to let) are available at www.milburys.co.uk